

Open Day

Wednesday 4th October 2023

9.10am - 10.40am 6.00pm - 8.00pm

Subject displays,
demonstrations and hands
on experiments for all the
family



Ofsted
Outstanding
Provider

**“Outstanding in
all areas”**
Ofsted

“The curriculum is a real strength of the school and demonstrates leaders’ strong moral compass. It combines academic excellence with a strong focus on pupils becoming effective and well-rounded individuals.”
Ofsted

“Teachers’ high expectations are at the heart of teaching in the school. Pupils’ progress has been extremely strong, including for the most able and pupils who have special educational needs and/or disabilities.”
Ofsted



ILKLEY GRAMMAR SCHOOL

A MOORLANDS TRUST ACADEMY

All welcome



Headteacher’s Presentations at 5.30pm, 6.00pm, 6.30pm & 7.00pm in B Hall

Marshall Building: What's on Where?

B Hall	<p>There will be a Headteacher's address from Mrs Carly Purnell at 5.30pm, 6.00pm, 6.30pm and 7pm.</p> <p>Please plan your tour of school around one of these presentations.</p>
Drama: B8, B7	<p>B7: Come and see members of our School Production 'Grease' rehearsing sections of the show.</p> <p>The production is on from 5th-8th February 2024.</p> <p>B8: Come and see our GCSE Drama students rehearsing their Devised Performances.</p>
Maths: D2, D4	<p>D2: Apply your understanding of ratio and proportion to mix yourself a tasty mathematical mocktail at the Fibonacci's Juice Hut. D4: Come and explore how we use technology in mathematics with a range of games, puzzles and interactive quizzes.</p>
Art: A10, A11 Photography: A7	<p>Art: Come along to art and take part in our 'take a line for a walk' activity. Meet our students, see their work and have a chat about art at IGS.</p> <p>Photography: Come along to Photography and join us in making a Photocollage. You can also meet our students and see their work.</p>
Library	<p>The library has an impressive, and expanding, collection of books, both fiction and non-fiction, plus academic journals. Please come along to participate in our reading based activities including our book trial challenge.</p>
Music: C8, C9	<p>GCSE and A Level students will be working on their compositions and performances in C8. In C9, there will be activities based on our curriculum from some of our extra-curricular groups.</p>
Inclusive Learning Zone & Nurture Centre Library	<p>Our Inclusive Learning Team will be available in the lower library to answer any questions you may have. In this zone you will be able to find more information about:</p> <ul style="list-style-type: none"> • Support that is available for children with additional needs. • The processes we use to identifying and responding to students needs. • How we use ClassCharts to inform teachers about additional and medical needs. • Interventions that are delivered to support students. • The Bungalow - our school resourced provision for students with Autism and ASD. • How we use assistive technology to support students in the classroom. • How teachers use responsive teaching to support students in the classroom. • How we use Learning Support Assistants to develop student independence.
Technology: Textiles E1	<p>Year 13 students will be producing designs, modelling techniques, and illustrating ideas for their non-exam assessment. Previous GCSE and A Level outcomes and portfolios will be available to view. Year 9 will be on hand to help create recycled polymer bookmarks to take away.</p>
Hospitality & Catering/Event Management/ Food Technology E2 & E4	<p>E2: See, touch and smell. See our Calamity Kitchen, can you see the hazards that are on show! Do you know your fruits from just touch? Come and test yourself. Can you identify the smell of herbs and spices?</p> <p>E4: Watch our talented year 11 students create two complex dishes and present them to restaurant standard as part of the Rotary Club cooking competition.</p>
Heath and Social Care E3	<p>Year 11 students will be hosting activities related to Heath and Social Care. Visitors will be invited to try to "Guess the Celebrity" from childhood pictures, direct emergency vehicles in order of priority and make their own bracelets!</p>
Personal Development and the IGS Journey Armitage	<p>Personal Development is the unique combination of experiences in lessons and beyond that lead to the development of qualities such as: integrity, curiosity, aspiration, confidence, character, insight and empathy, alongside reinforcing our school values.</p> <ul style="list-style-type: none"> • Come to the Armitage building to find out more about our Personal Development Curriculum and how it builds year on year so that students emerge fully prepared for the ever-changing world in which we live. • The 8 strands which form the 'web' of Personal Development at IGS are: Active Citizenship & Community, Leadership & Influence, Scholarship & Curiosity, Next Steps and Careers, Sport, Interests & Culture, Health & Wellbeing, Respect, Equality & Diversity and Discovery & Adventure. <p>We deliver these experiences through: Personal Best Time (PBT), tutor time, assemblies, PSHE lessons, break, lunchtime and after school activities, as well as through activities in lessons and out of school. Find out more about the IGS Personal Development journey and where it could take you.</p>
e-Learning Centre: K2 & K3	<p>A chance to see our computing curriculum in action! Our students are creating 3D images using Photoshop; they are designing arcade style games using Scratch and learning to code in Python. There will also be an opportunity to learn more about how robots work by programming and controlling a Sphero. Come and take on the Sphero challenge!</p>
Media Studies: K5	<p>Come and watch us recording a Media Studies television broadcast!</p>
Science: Biology D5	<p>This is your opportunity to participate in a variety of experiments and hands on activities from bull's heart dissection to bursting red blood cells and blowing up lungs!</p>

Bronte & Armitage Building: What's on Where?

Technology Centre: L1/L5	Come and explore our design projects and meet our year 12 & 13 students in our dedicated CAD & CAM suite. Visit L1 to explore our workshops, race a car with our KS3 pupils and make a new keyring using our laser cutter and 3D printers!
PE: Sports Hall, Gym and Pool	A variety of sporting activities will be on display for both parents and students to watch and take part in. Both PE staff and Sports Leaders will be delivering the sessions. <ul style="list-style-type: none"> Gym - Fitness testing 6-7pm and dance showcase 7-8pm. Sports Hall - Netball showcase 6-7pm and badminton/basketball 7-8pm. Swimming Pool - Water polo/swimming 6-8pm.
Humanities: RE P2	Come and create your own concept using our Play Doh. Write a thought of your own on our philosophy board. Answer the Think or test your skill in our 'Match the Artefact' competition.
Science: Chemistry P7	A variety of exciting experiments and activities: there'll be plenty of bubbles, fire, explosions and some colorful chemistry demonstrations. All of these are just a taster of what awaits you as a chemistry student at IGS!
Modern Foreign Languages: N3 and N6	Have a go at practising your language skills or simply relax in our International Café; peruse photographic displays of our popular exchange visits and be wowed by the results of our cross curricular Languages Festival; have a go at our Kahoot quiz; learn language iPad skills whilst sampling delicacies provided by our student ambassadors. Plus, get in with a chance of winning one of our raffle prizes provided by local businesses.
Humanities: Geography M6	Explore the digital age of geography by playing on our Geographical Information Systems. Add your own ideas to our display showing British identity. See what the Geography of Food is all about. Have a look at the types of fieldwork we carry out in key stage 4 and 5 or simply chill out and watch the wonder of our world in the Power of the Planet.
Humanities: History M8	Come and see the famous Neolithic body of Tollund man and solve our historical mystery. Can you use the evidence to work out who he was? Demonstrate your skill as an archeologist and guess the artefact in our 'What on Earth is it?' competition and why not talk to our key stage 3 students who can share their experiences of history with you?
KS3 Science: M9	Get hands-on with some fun-filled and surprising experiments in the KS3 science room. Experiments and demonstrations on show will include 'money to burn', 'rainbow fizz', the 'magic of magnets' and 'making your own lava lamp'.
Science: Physics M10	Can you escape from an evacuated bin liner? How long can you defy gravity? Can you explain the jumping ring? Would you like to see your voice? Can you bring down the giant Jenga, one block at a time? Some physics experiments await you!
IGS Catering Team Armitage Café	Come to the Armitage Café to sample our innovative taster menus and talk about catering at Ilkley Grammar School.
BMDC Admissions Armitage Café	BMDC Admissions' Representatives will be available to discuss any questions you may have about admissions.
Year 9 Introduction to Law P4	Don't know your barrister from your solicitor? Your youth court from your magistrates' court? Then this is the place for you! Come and have a go at our Legal-Eagle dominos and learn all about our Year 9 Introduction to Law course (with a little bit of Criminology thrown in!)
English: R1	Join us on our 'IGS English Curriculum Journey!' Our road map will lead you through our exciting new English curriculum, showing you the route our students embark on in year 7 right through to A Level study.
English: R2	There's been a murder! But who committed the grisly act, and what seminal work of literature inspired the killing? Solve the clues to reveal the answer to our murder mystery.
Business: Q1	Come and sample a whole host of business related activities including logo games and guess the strap line. Have a go and see where you sit on the live league table!
PSHE: P6	Personal, social, health and economic education (PSHE) forms a core part of our rich Personal Development experience. Our PSHE team will be available in P6 to answer any questions you may have about PSHE at secondary school. You will be able to find out more about: <ul style="list-style-type: none"> The PSHE Curriculum How PSHE fits into wider Personal Development How teachers create a safe and inclusive classroom environment for PSHE learners

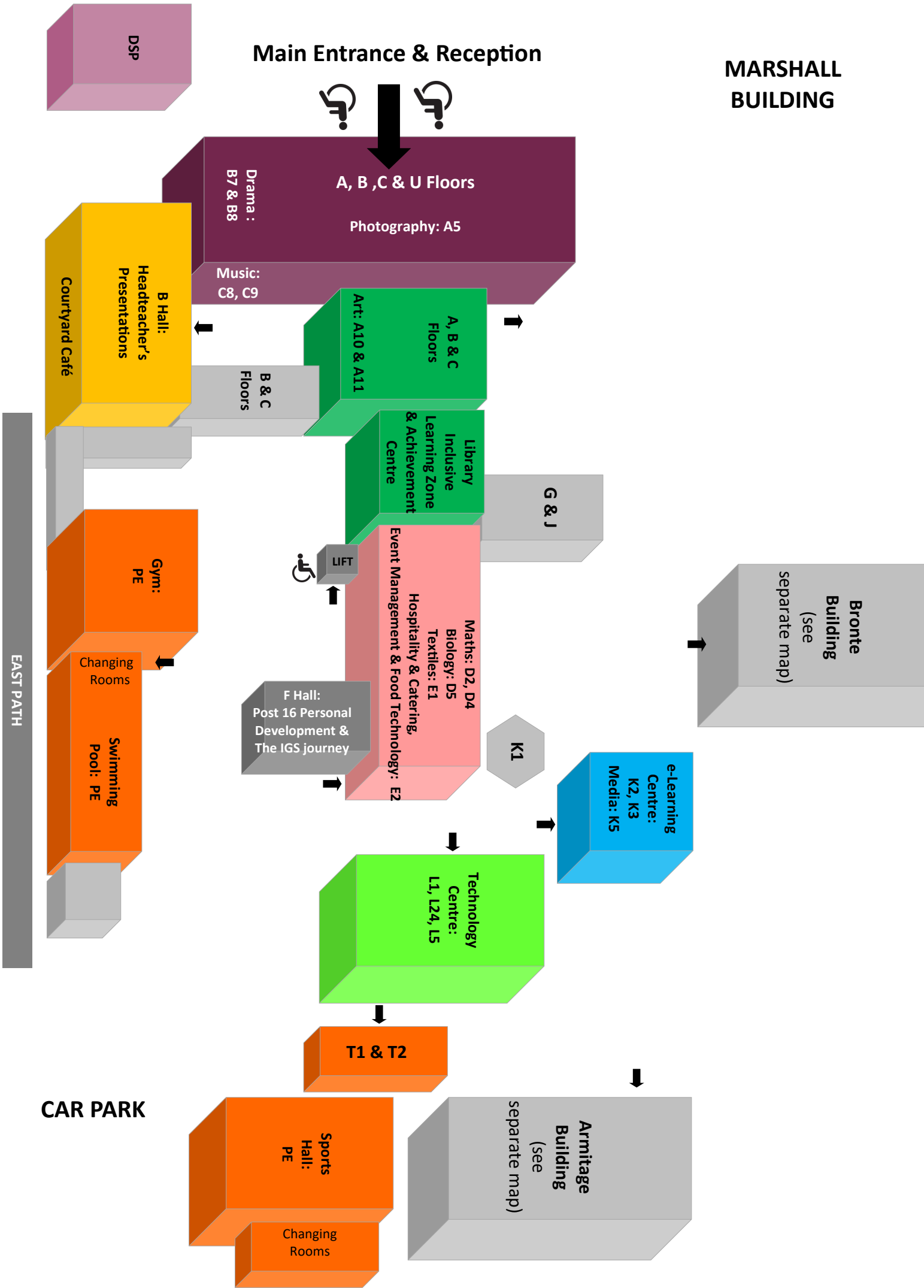

BRONTE BUILDING

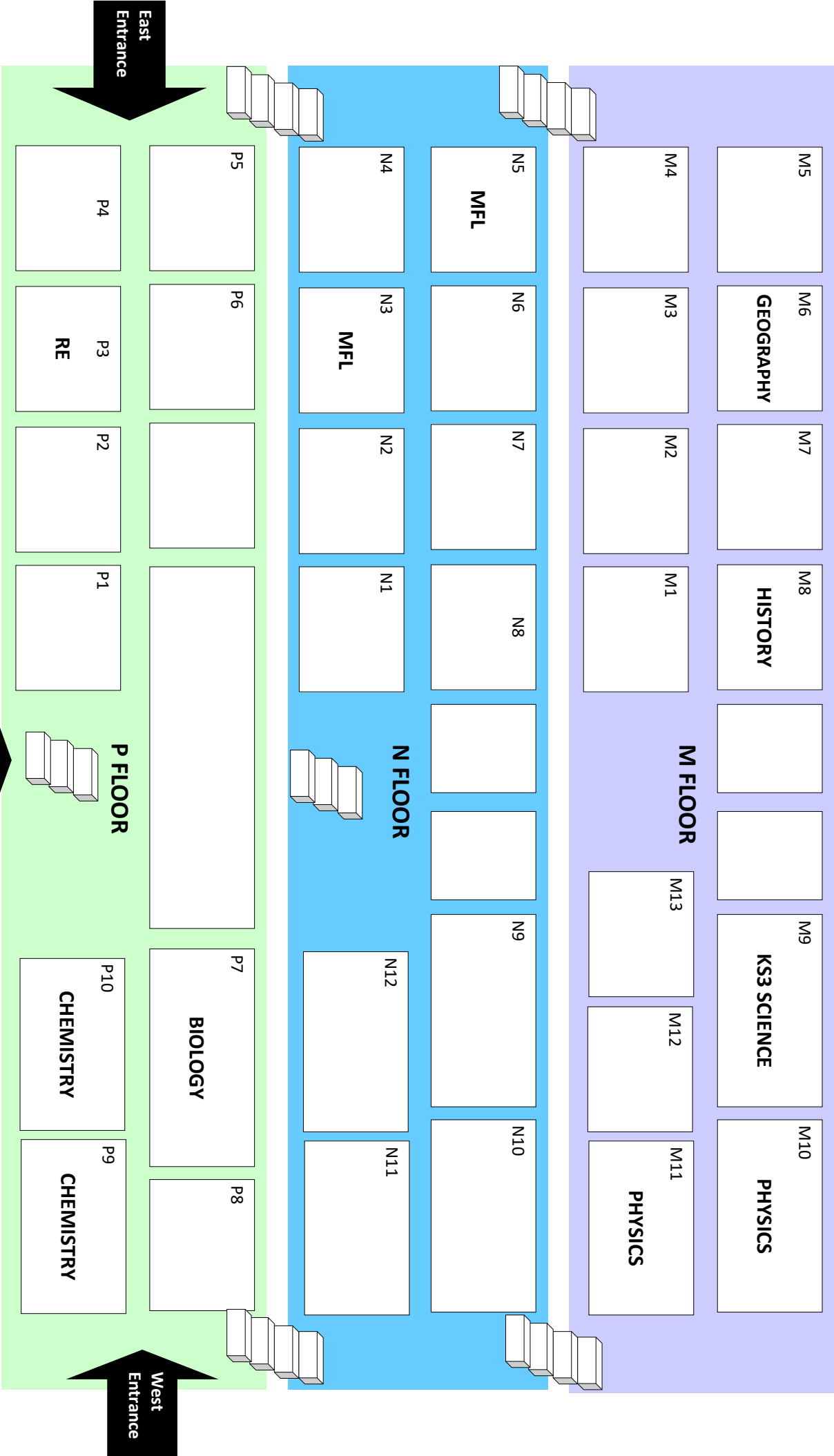

ARMITAGE BUILDING

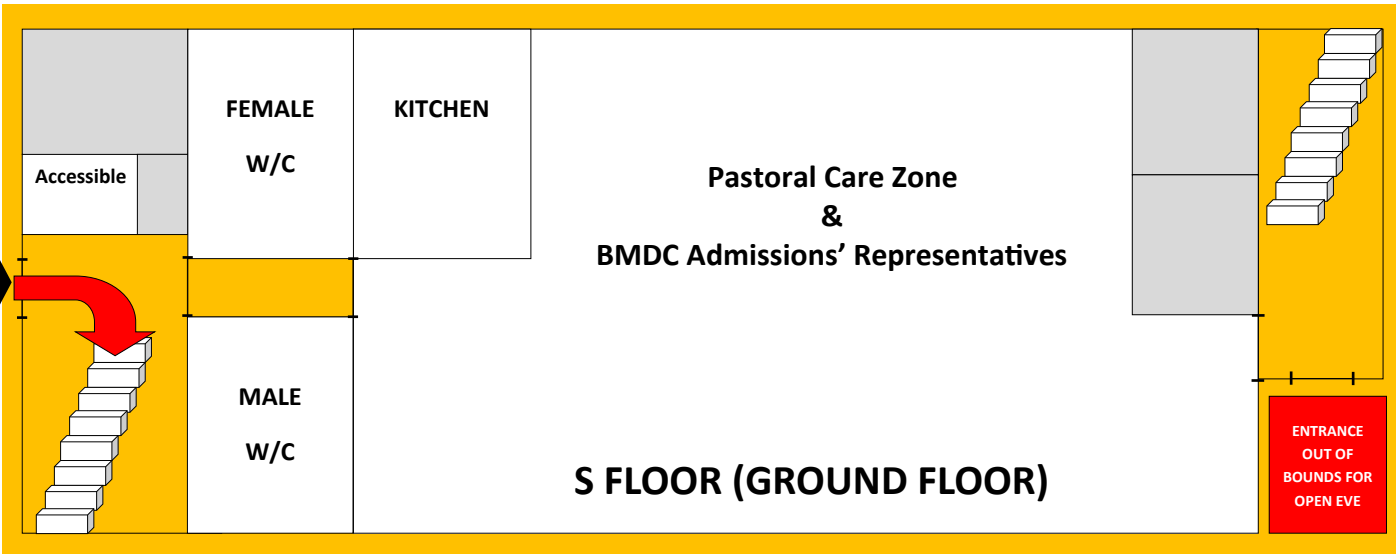
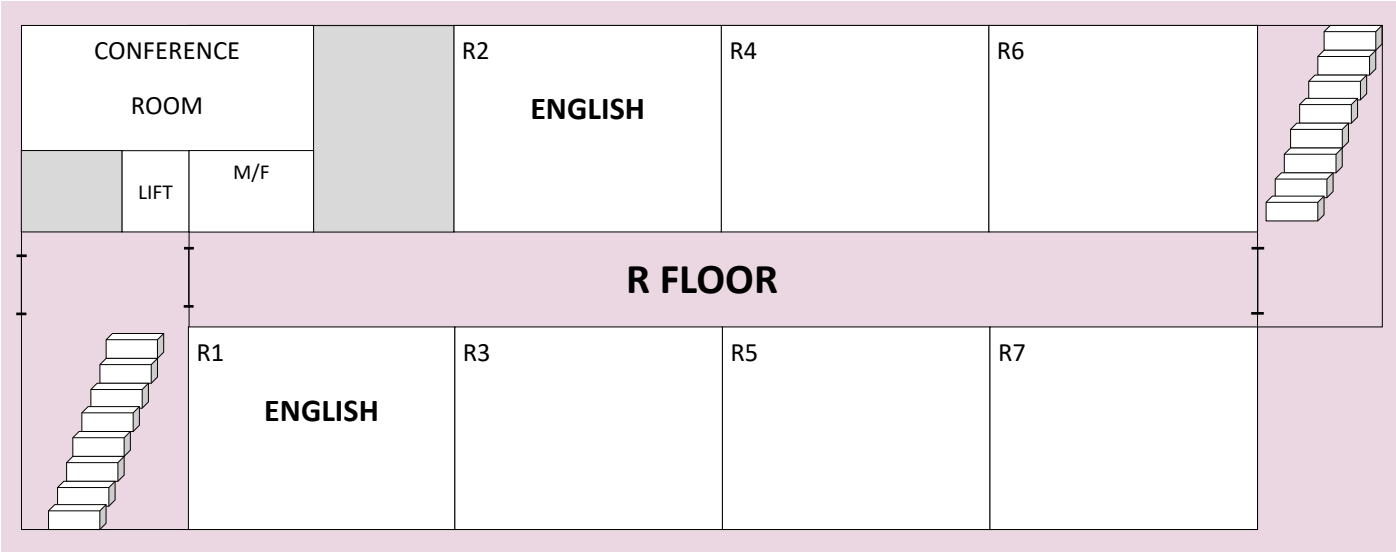
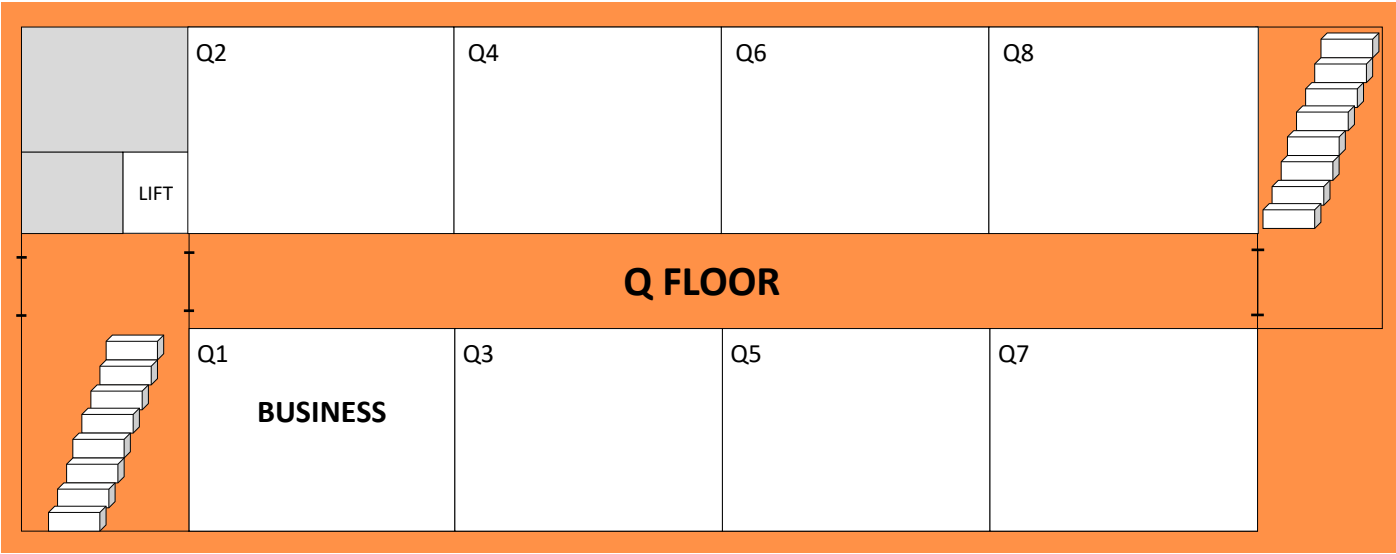

We are proud of our
Transition Programme
at IGS...making the
change from
Year 6 to 7
is great fun!

... science



... sport



... English



... drama



... technology



... and music





ILKLEY GRAMMAR SCHOOL

A MOORLANDS LEARNING TRUST SCHOOL

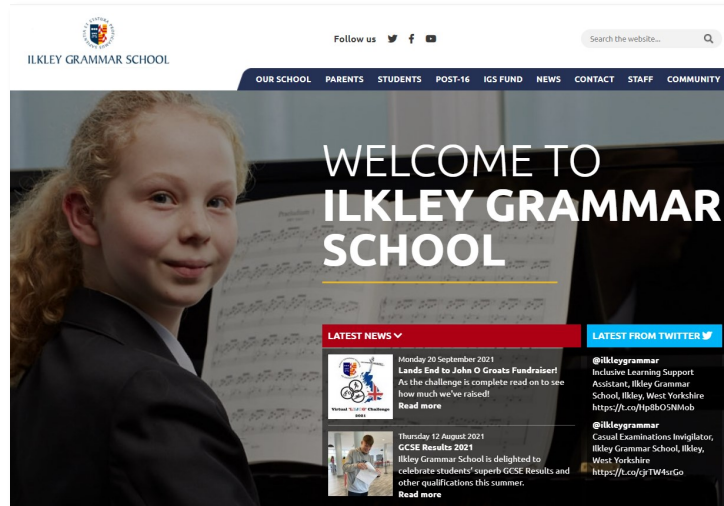

If you would like to find out more about Ilkley Grammar School, please visit our website:
www.ilkleygrammarschool.com or follow @ilkleygrammar on Twitter and YouTube

